



256L SANDBLAST CABINET

OPERATING AND MAINTENANCE INSTRUCTIONS

MODEL: 4100-420



SAVE THIS MANUAL

You will need this manual for the Safety instructions, assembly and operating instructions and parts list. Put it in a safe dry place for future reference.

SPECIFICATIONS

CHARACTERISTIC	VALUE
Overall dimensions	960MMx630MMx650MM
Gross Weight/Net Weight	51KGS/45KGS
Electrical Requirements of light	230V
Maximum operation pressure	125PSI

SAFETY WARNING & CAUTIONS

1. KEEP WORK AREA. CLEAN CLUTTERED AREAS INCIDTE INJURIES.
2. KEEP CHILDREN AWAY. ALL children should be kept away from the work area. Don’ t let them handle tool.
3. WEAR GOGGLES or SAFETY GLASSES DURING OPERATION. GLASS
4. LENS IS 5MM TEMPERED, BUT STILL BREAK. Replace only with
5. Safety Glass. Size: 610MMx3.4MM.
6. USE GROUNDED RECEPTACLE ONLY for electrical hookup. Require 110/230 colts to operate vacuum.
7. REPLACE GLOVES. Cabinet gloves do wear. Replace as necessary.
8. CLOSE AND LATCH DOOR DURING OPERATION.
9. DISCONNECT INCOMING AIR LINE when adding abrasive. Or when Servicing hoses. power gun. or other components.
10. MAXIMUM OPERATING PRESSURE-125PSI

ASSEMBLY

GASKET INSTALLATION

1. Place foams foundation of net on table or bench.
2. Peel off paper backing from 1'' wide foam gasket and apply to lip of frame foundation.
3. Trim length of gasket as needed.
4. Use a punch or nail to make holes in funnel gasket for bolt installation.

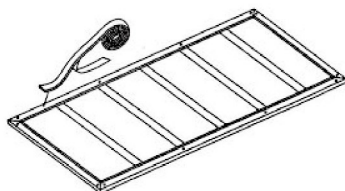

LEG INSTALLATION

1. Place cabinet on its back on a table or Bench.
2. Remove M6x12 bolts, nuts lock washer, & washers from bolt packet.
3. Insert M6x12 bolt through leg & into cabinet.
4. Place M6 washer and M6 lock washer over bolt and M6 hex nut. Hand tighten.
5. Repeat above for remaining three legs.

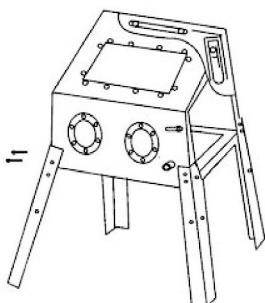

FUNNEL, NET AND FRAME

FOUNDATION OF NET INSTALLATION

1. Stand cabinet upright.
2. Place net on frame foundation of net, then place the net and frame foundation of net on funnel.
3. Remove four M6 x 20 bolts and washers and four hex nuts from bolt package.
4. Insert four M6 x 20 bolts and washer through holes in funnel frame foundation into cabinet. Place washers and nuts over bolts and tighten.

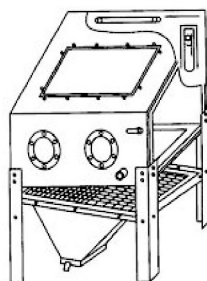

SHELF INSTALLATION

1. Stand cabinet upright.
2. Remove eight M6 x 12 bolts, 16 washers and Eight hex nuts from bolt package.
3. Insert eight M6 x 12 bolts and washers through Holes in leg and shelf, place washers and M6 Lock washers and nuts over bolts and tighten.
4. Tighten leg bolts and level cabinet.

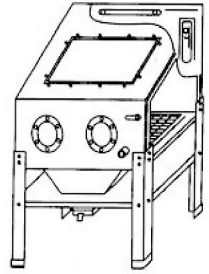

CABINET LEG TRIM MOULDING

Enclosed are four trim Mouldings for bottom Of Cabinet legs. They may be pushed in place, without tools.

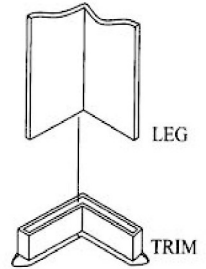

AIR REQUIREMENTS:

For best results, we recommend a good 5HP air compressor. A small nozzle/air jet Combo is use with a 3HP air compressor.

HOW IT WORKS

Your shop air hose enters front opening of cabinet and is connected to the air inlet of Power Gun. Bottom handle of gun has 1/4'' pipe threads which will fit most air hose. Cabinet pickup tube leads to clear siphon hose which connects to gun head Assembly.

Pour glass beads or other abrasive into cabinet hopper through the side loading Door. Place parts to be blasted in cabinet and close door with hands in cabinet gloves .

Aim power gun at object. Pull trigger and let our unique siphon recycling system do the rest. Rust, paint and scale are quickly removed leaving the

original metal clean and intact. Abrasive drops to the bottom of cabinet for continual recycling each time power gun is activated.

Abrasive can be re-used until it eventually breaks down or becomes dusty. To discard worn abrasive simply empty box under spring loaded trap door. Add more abrasive and resume blasting.

Your shop vac connects to vacuum ferrule is necessary to the dust created in blasting. When using a shop vacuum, be sure to install the paper filter over standard filter. Otherwise, abrasive could work its way into the vacuum motor causing bearing failure.

At right front of cabinet is an opening for your air hose from your compressor an ordinary 3/8" ID air hose should fit through this opening. Connect your air hose should fit through this opening. Connect your air hose to bottom handle of power gun by screwing into place (use teflon tape or pipe compound—do not over tighten). Close door and pull trigger a few times to test operation.

You are now ready to add abrasive.

Add suitable abrasive by pouring through side door opening and allowing it to fill funnel area. Do not over fill (1/2 full below work area screen is best).

NOTE: use a fine grade of abrasive to prevent clogging. We recommend straining through a double layer of ordinary window screen. If it passes through the screen. It will pass through the nozzle.

YOU ARE READY TO START BLASTING.

PARTS LIST

Part	Description	Qty
1	Window frame (646*342mm)	1
2	organic glass	1
3	white glass	1
4	Protective film	4
5	Side door	2
6	sealing strip(15*8mm)	2
7	latch	2
8	Glove retaining ring	2
9	Glove inside retaining ring	2
10	Glove(large size)	2
11	hoop %c170-190	2

Part	Description	Qty
12	Standing leg	4
13	Baffle plate	1
14	bracket	1
15	sand container	1
16	bottom Net frame	1
17	top Net frame	1
18	sandblasting box	1
19	switch box	2
20	Filter element with sponge	1
21	Filter fixator	1
22	Air vent Sealing ring	1

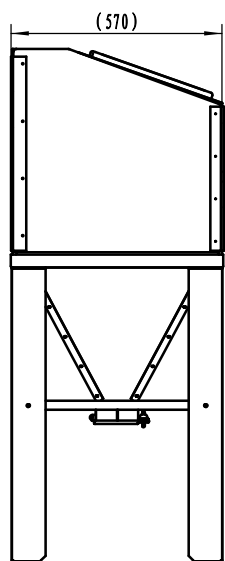
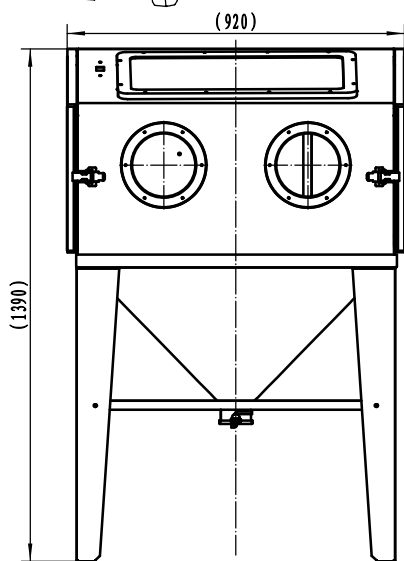
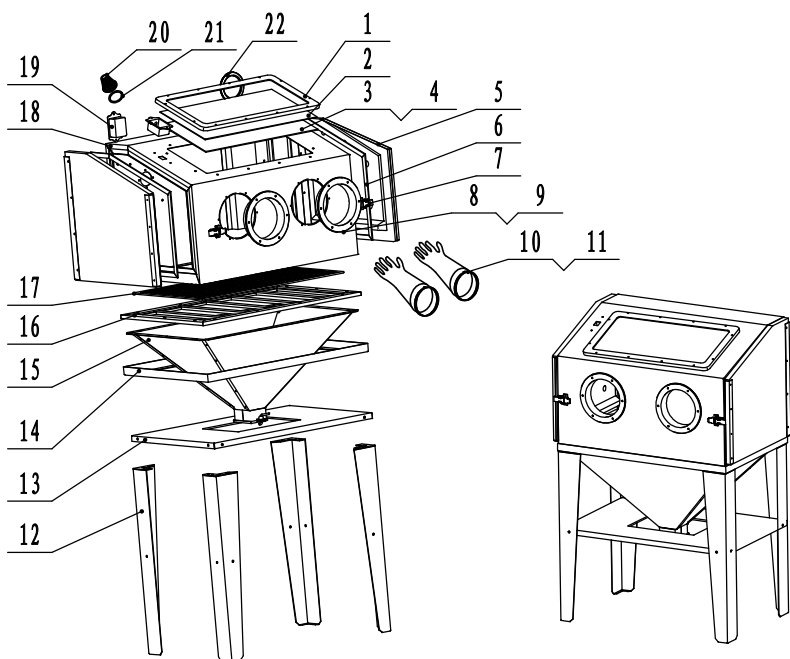

Part	Description	Qty	Unit	Remarks	Part	Description	Qty	Unit	Remarks
Assembled parts					Assemble your own accessories				
1	LED lamp	1	pcs	Assembly of lamp and switch box	27	Sand-blasting gun	1	pcs	
2	Lamp clips	2	pcs		28	Big lid	1	pcs	
3	Lamp line	1	pcs		29	Flange cover	1	pcs	
4	Red and white cable tie	1	set		30	Flange	1	pcs	
5	Switch box	1	pcs		31	Collodion （1.5*2.0cm）	1	pcs	
6	Inlet seal ring	1	pcs		32	Triangular foot pad	4	pcs	
7	Glove clamp	1	set	Glove fitting	33	PTFE Tape	1	pcs	
8	Gloves	1	set		34	Ceramic nozzle Ø4.5 Ø5 Ø6 Ø7(Ø4.5 mounted on gun)	4	pcs	
9	Big rubber seal ring	1	set		35	Hexagonal straight inner wire 1/4"	1	pcs	1pack
10	Glove mounting ring	1	set		36	Outer silk water nozzle connector	2	pcs	
11	Pressure frame	1	pcs	Glass fitting	37	Plain washer Ø12	1	pcs	
12	Plexiglass	1	pcs		38	Rubber plain washer Ø12	1	pcs	
13	White glass	1	pcs		39	Hoop Ø8-Ø12	2	pcs	
14	Door locker	2	pcs	Door fitting	40	Hoop Ø16-Ø25	2	pcs	
15	Left door	1	pcs		41	Air pipe Ø10*800	1	pcs	
16	Right door	1	pcs		42	Sand suction hose Ø14*800	1	pcs	
Unassembled parts					43	Flat head screw Ø6*12	12	pcs	For bottom frame and foot assembly
17	Left leg	2	pcs		44	Nut Ø6	12	pcs	
18	Right leg	2	pcs		45	Spacer Ø6*12	12	pcs	
19	Bracket	1	pcs		46	Pan-head screw Ø6*12	18	pcs	1.Partition board: 8pcs 2.Triangular foot pad: 8pcs 3.Sand suction tube: 2pcs
20	Sand suction tube	1	pcs		47	Nut Ø6	18	pcs	
21	Network frame	1	pcs		48	Spacer Ø6*12	18	pcs	
22	Partition board	1	pcs		49	Pan-head screw Ø6*30	14	pcs	For bottom frame and sand bucket box assembly
23	Sand container	1	pcs	Equipped	50	Nut Ø6	14	pcs	
24	Sand box	1	pcs		51	Spacer Ø6*30	14	pcs	
Spare parts list					52	Pan-head screw Ø5*10	4	pcs	For flange assembly
25	PVC protective Film(Paste 1 pack of 4)	5	pcs		53	Nut Ø5	4	pcs	
26	Manual	1	pcs		54	Power adapter	1	pcs	